

Fontana Deauville Rainfall Waterfall Wall Mounted Shower Panel with Massage Jets, Hand Sprayer and Tub Spout in Rose Gold Finish



BEFORE YOU BEGIN

Before you begin, please read the installation instructions below. Observe all local building and safety codes.

Unpack and inspect the items for any shipping damages. If you find damages, do not install.

Please note all products must be installed by a professional and certified plumber otherwise warranty might be voided.

POSSIBLE TOOLS REQUIRED*



Plumbers Tape



Tape Measure



Level



Adjustable Wrench



Hex Wrench



Thread Sealant



Drill



Pencil or Marker



Screwdriver

*not included

A. Direct Connect Instructions

IMPORTANT: In order to install this shower panel, simple un-derstanding of plumbing techniques will be necessary. Please contact a professional plumber if you are unfamiliar with plumbing techniques or require assistance.

Prerequisites:
-separate cold and hot water supply lines

NOTE: This shower panel replaces any mixing valve you are currently using.

Step 1

Begin by roughly measuring the position of the shower panel rela-tive to your height and mark the location desired.

Step 2

Remove the shower panel and locate the position of the mounting brackets (red arrows). Take measurements and then transfer those marks to the location of the wall. Mark the center point of the location of the mounting brackets.

Step 3

Using a drill, attach the wall mounting brackets with the included hardware. An extra set of hands may be required for the following steps. Lift and locate the hot and cold water lines on the shower panel (red circle).

Step 4

Connect the hot and cold water supply lines to the flexible hoses. Be sure to use the included washers. It is recommended a 3/8" right angle connection be installed to better route the flexible hoses (see diagram).

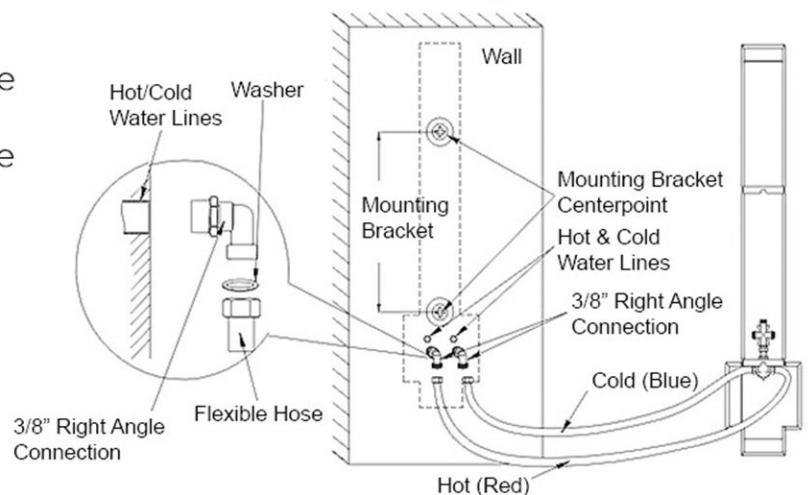

Step 5

Once connected, lift the entire shower panel and hook it to the wall using the mounting brackets. There are two types of mounting brackets used for our shower panels. Check the next page for de-tailed mounting instructions.

Step 6

Check if the unit is leveled. Test out all shower functions including the water temperature to finish installation.

NOTE: If you're water temperature is either too hot or too cold, please check the hot and cold water lines. The connection may be reversed (cold to hot).

Step 7

Complete the installation by using silicone sealant around the pe-rimeter of the shower panel. Your installation is now complete.

B.Easy Connect System Instructions

Step 1

Before beginning installation, ensure the shower panel has suffi-cient space between the shower-head and pre-existing tempera-ture controls.

Step 2

With the water turned off, remove your shower-head and arm from the wall. Note: Standard 1/2" connections are used.

1



2

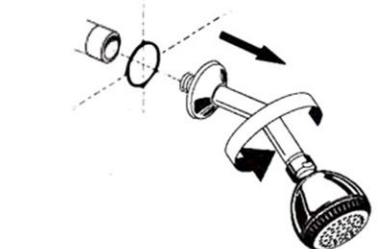

Step 3

Connect the included Brass Extender Joint (1/2" size) to the exist-ing showerhead pipe outlet. Multiple sized brass extenders may be included. Choose the one appropriate for your wall thickness. Use Teflon tape for a secure seal.

3

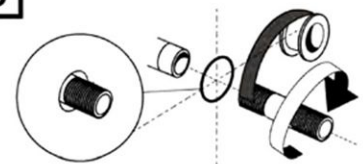

Step 3a

Peel off the adhesive backing from the Base Plate Cover.

a.



b.

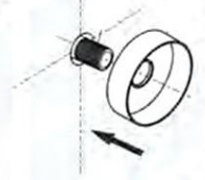

Step 3b

Adhere the Base Plate Cover to the wall. Note: Make sure the wall surface is free of dirt and residue.

Step 3c

Join the Elbow Connector and Main PVC Pipe assembly to the Brass Extender Joint by turning clockwise. Do not over tighten.

c.

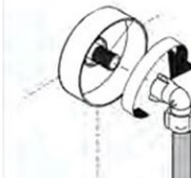

d.

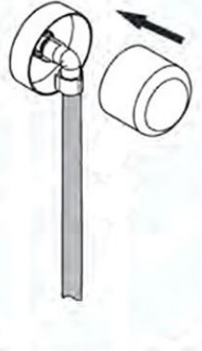

Step 3d

Install the Showerhead Connector Cover.

Mounting Instructions: Type A

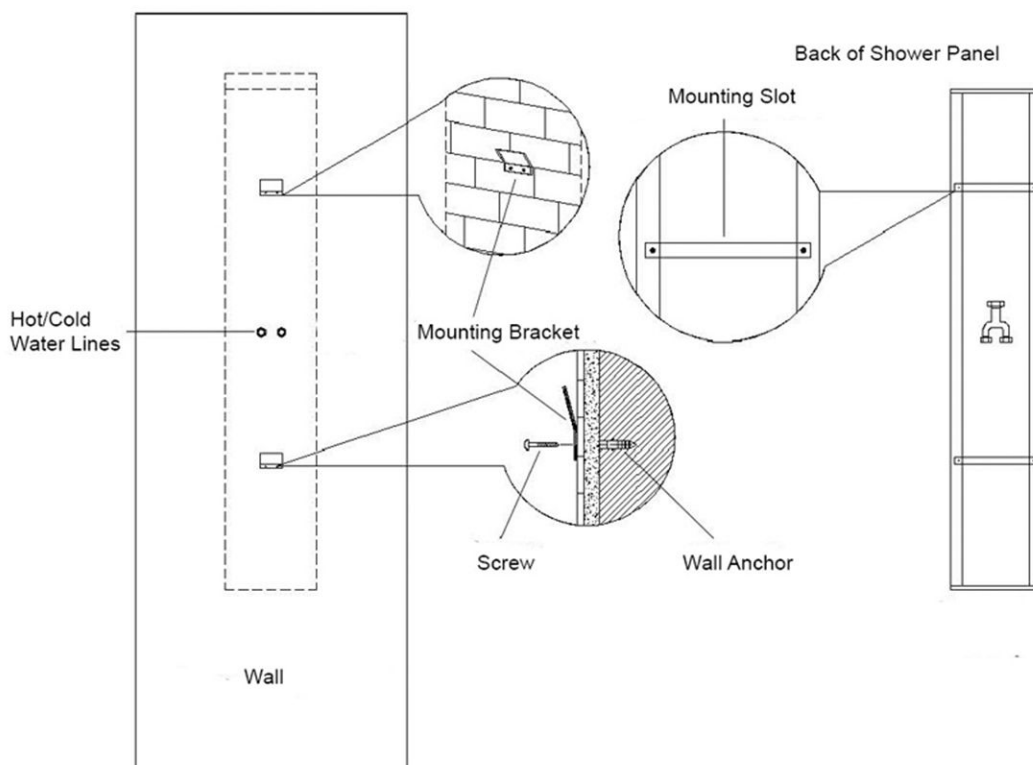

Mounting Instructions: Type B

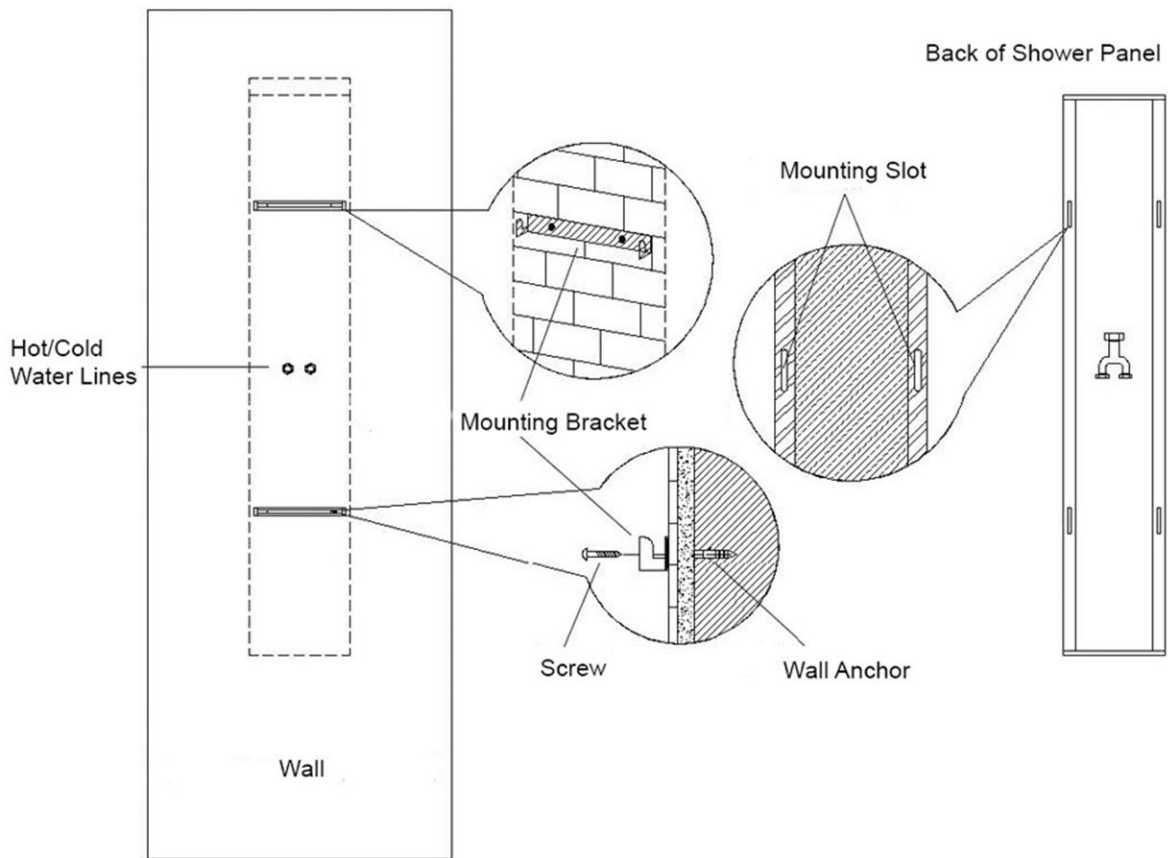

Use and Care Guide

Shower Panel Body

Acrylic or tempered glass shower panels may show water spots. A mild household cleaner will remove them.

Aluminum or stainless steel shower panels can be cleaned with a mild cleaner.

Note: Avoid abrasive cleaners or harsh scrubbing pads (acetone, Ajax, Comet, or other solvents).

Showerhead and Body Jets

Both the showerhead and body jets use non-clogging rubber nozzles that can remove calcium deposits just by rubbing your finger along them. If clog remains, please use CLR or other hard water cleaner.

Note: Avoid abrasive cleaners or harsh scrubbing pads (acetone, Ajax, Comet, or other solvents).